



CORPORATE OFFICE

DD Trade Tower, 2nd Floor, Kaloor - Kadavanthra Road, Ernakulam, Kerala, India. Pin - 682 017

Tel : +91 484 4177888, E-mail : sales@desaihomes.com

www.desaihomes.com

Branches : Trivandrum, Kottayam, Thrissur, Calicut



K-RERA/PRJ/ERN/061/2024

www.rera.kerala.gov.in



An ISO 9001 - 2015 Certified Company

www.desaihomes.com



THE
LANDMARK
OF COMPANYPADY

www.spotcreative.in/9037472529

Illustrations are indicative only.



LEGACY OF TRUST

8.5⁺

Million Sq. Ft.
Completed & Ongoing Projects

61⁺

Completed &
Ongoing Projects

6.5k⁺

Satisfied
Customers



DESAI HOMES

A Concrete Business Move

An ISO 9001 - 2015 Certified Company

Desai Homes is a part of the fast-growing Desai Group Of companies having its presence in Kerala since 1992, Desai Homes has played a pivotal role in the development of the real estate scenario in Kochi. Desai Homes with 32 years of industry expertise, backed by a robust customer base of 6,500 satisfied clients and an impressive portfolio encompassing 8.5 million square feet and a total of 61 projects including the ongoing ones in Kerala, we are poised to bring exceptional value to this emerging locale. Our seasoned team is dedicated to delivering quality developments that meet the highest standards, ensuring that our new project will continue our legacy of excellence and innovation in the real estate sector.





2 & 3 BHK

1000sq.ft. - 1131sq.ft.

16 FLOORS

128 UNITS

Experience a
**GRAND LIVING
AT DD GLOBAL
KINGDOM!**

K-RERA/PRJ/ERN/061/2024



DD Global Kingdom is the latest landmark development by Desai Homes, crafted for those who thrive on the vibrant energy of city life. Located near to companypady metro station in between Kalamassery and Aluva, the project offers all the conveniences of urban living within easy reach. Whether it's shopping, entertainment or essential services, everything you need is just a short distance away.

DD Global Kingdom offers you a total of 128 units of 2 & 3 BHK Apartments that ranges from 1000 sq. ft. to 1131 sq. ft. in a single tower with basement, ground plus 16 floors. With thoughtfully designed homes and a host of modern amenities, including fitness center and indoor game zones, DD Global Kingdom offers a perfect blend of serenity and urban practicality. This project is the ideal choice for individuals, who embrace the dynamic, fast-paced lifestyle of the city while still enjoying the comfort and security of a well-managed community.





Live
**THE LIFE
YOU
DESERVE!**

Welcome to DD Global Kingdom, Our meticulously crafted residences offer the ultimate in privacy and comfort, providing an oasis of tranquility amidst the bustling city. DD Global Kingdom stands out, offering a unique opportunity to be part of an exclusive, high-class society. Every detail, from the elegant spaces to the thoughtfully planned community areas, is designed to enhance your lifestyle and offer a perfect blend of comfort, privacy, and convenience.

Your
**GATEWAY TO
URBAN
LIVING!**

DD Global Kingdom is strategically located just 3 kms. away from Kalamassery towards Aluva and 700 mtrs. away from National Highway. This prime location places you moments away from essential services, including the International Airport, railway station and esteemed educational institutions. Additionally, the project is in close proximity to LuLu Mall and the Metro station, offering unparalleled ease of travel and access to premier shopping experiences. Enjoy the advantages of city living with easy access to shopping hubs and major places of worship. In this bustling metropolitan environment, you'll find the perfect balance of connectivity and comfort, making DD Global Kingdom your ideal urban sanctuary.



TYPICAL FLOOR PLAN

2nd to 16th



• Furniture layout and fixtures are indicative only • Dimensions may vary slightly during construction • All dimensions are in centimeters



• Furniture layout and fixtures are indicative only • Dimensions may vary slightly during construction • All dimensions are in centimeters

TYPE-A
2 BHK 2nd to 16th Floor

SUPER
BUILT UP AREA 1007 Sq.ft

RERA CARPET
AREA 650 Sq.ft
(Including Internal Walls & Toilets, Excluding Balcony)

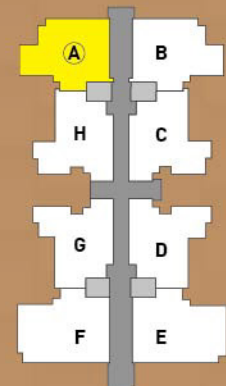

KEY PLAN



• Furniture layout and fixtures are indicative only • Dimensions may vary slightly during construction • All dimensions are in centimeters



TYPE-B 2 BHK

2nd to 16th Floor

**SUPER
BUILT UP AREA** 1007 Sq.ft

**RERA CARPET
AREA** 650 Sq.ft

(Including Internal Walls & Toilets, Excluding Balcony)

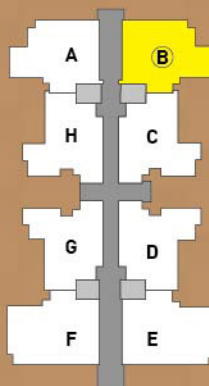

KEY PLAN



• Furniture layout and fixtures are indicative only • Dimensions may vary slightly during construction • All dimensions are in centimeters



TYPE-C 2 BHK

2nd to 16th Floor

**SUPER
BUILT UP AREA** 1000 Sq.ft

**RERA CARPET
AREA** 636 Sq.ft

(Including Internal Walls & Toilets, Excluding Balcony)

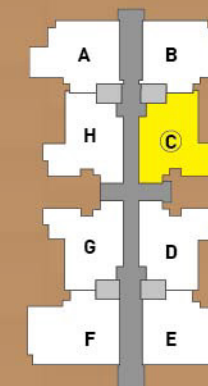

KEY PLAN





TYPE-D
2 BHK 2nd to 16th Floor

**SUPER
BUILT UP AREA** 1000 Sq.ft

**RERA CARPET
AREA** 636 Sq.ft
(Including Internal Walls & Toilets, Excluding Balcony)

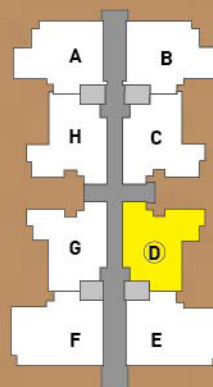

KEY PLAN

• Furniture layout and fixtures are indicative only • Dimensions may vary slightly during construction • All dimensions are in centimeters

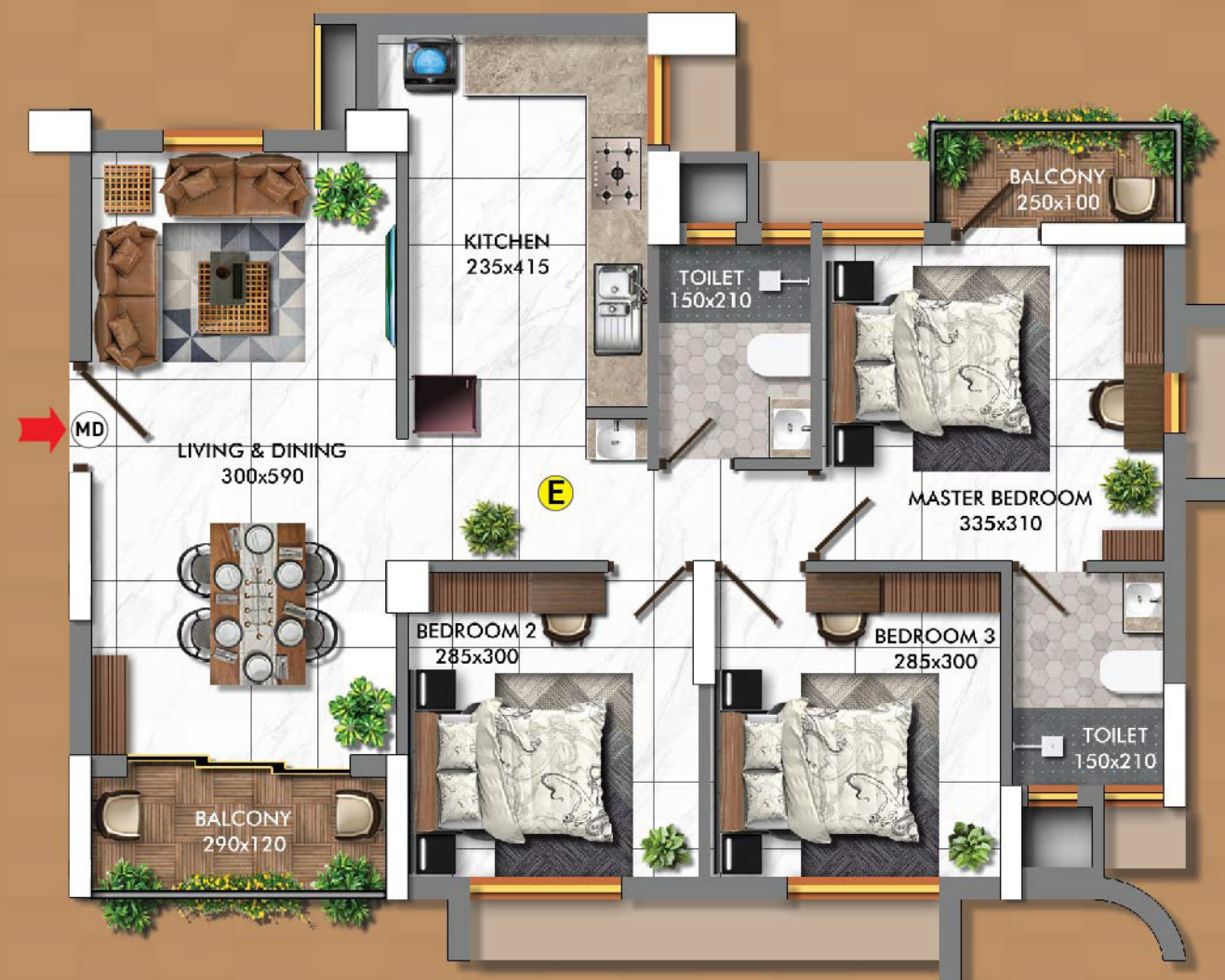

TYPE-E
3 BHK 2nd to 16th Floor

**SUPER
BUILT UP AREA** 1131 Sq.ft

**RERA CARPET
AREA** 731 Sq.ft
(Including Internal Walls & Toilets, Excluding Balcony)

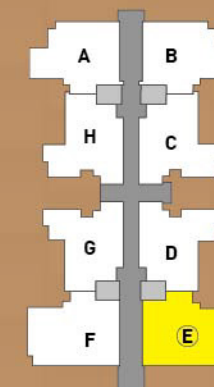

KEY PLAN

• Furniture layout and fixtures are indicative only • Dimensions may vary slightly during construction • All dimensions are in centimeters



TYPE-F
3 BHK 2nd to 16th Floor

**SUPER
BUILT UP AREA** 1131 Sq.ft

**RERA CARPET
AREA** 731 Sq.ft
(Including Internal Walls & Toilets, Excluding Balcony)

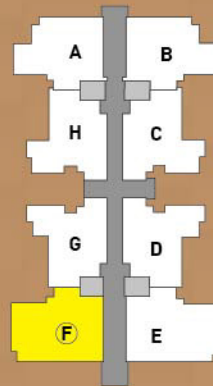

KEY PLAN

• Furniture layout and fixtures are indicative only • Dimensions may vary slightly during construction • All dimensions are in centimeters



TYPE-G
2 BHK 2nd to 16th Floor

**SUPER
BUILT UP AREA** 1000 Sq.ft

**RERA CARPET
AREA** 636 Sq.ft
(Including Internal Walls & Toilets, Excluding Balcony)

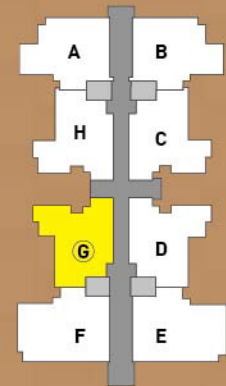

KEY PLAN

• Furniture layout and fixtures are indicative only • Dimensions may vary slightly during construction • All dimensions are in centimeters





TYPE-H 2 BHK

2nd to 16th Floor

**SUPER
BUILT UP AREA** 1000 Sq.ft

**RERA CARPET
AREA** 636 Sq.ft

(Including Internal Walls & Toilets, Excluding Balcony)

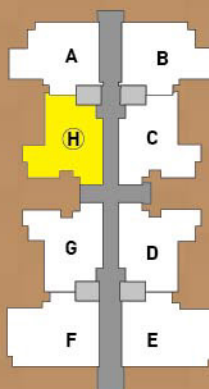

KEY PLAN

• Furniture layout and fixtures are indicative only • Dimensions may vary slightly during construction • All dimensions are in centimeters

SPECIFICATION



FLOORING

- Premium quality vitrified tiles for living & dining, bedrooms and kitchen.
- Matt finished ceramic floor tiles in bathrooms and balcony.
- Glazed wall tiles up to false ceiling in bathrooms (Kajaria/AGL or Equivalent).



PAINTING

- Two coats exterior grade putty with one coat primer and two coats of plastic emulsion on the internal walls and ceiling.



FRONT DOOR

- Both side teak veneer finished factory made flush door fitted with high-quality Mortise lock (Dorset or equivalent).



INSIDE DOOR

- Both side veneer finished factory made flush door for bed rooms.
- Both side laminated HDF flush door with PVC lipping on four sides for bathroom.



BALCONY DOOR

- Powder coated aluminum fully glazed sliding door with provision for insect screens.



WINDOWS

- Powder coated aluminum openable windows.



CP FITTINGS

- Jaquar/ Hindware/ Cera or Equivalent.



SANITARY

- Floor mounted EWC with ceramic tank and wash basin in all bathrooms (Cera or Equivalent).



- PVC insulated fire retardant wires (V guard or Equivalent).



- TPN (3 Phase) Double Door Distribution Board with ELCB and MCB's (L&T or Equivalent).



- Sleek design modular switches (Honeywell or Equivalent).



AC POINT

- 1 point in 3BHK & 2BHK flats (Additional AC points will be charged extra).



16 AMPS PLUG POINTS

- 4 points in 3BHK & 4 points in 2BHK flat, including Geyser points in all bathrooms.



- Provision for Aqua Guard in kitchen



- Provision for exhaust fan in all bathrooms and kitchen.



- Glazed tile wall cladding in all floor passages up to 120cm height and vitrified tiles for flooring.

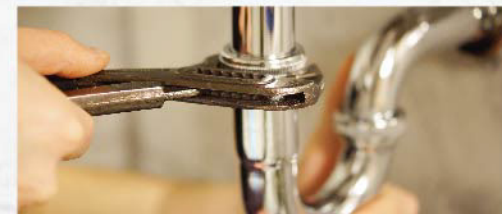

AMENITIES



- Health Club
- Indoor Games
- Pool Table
- Mini Hall
- Meeting room



SOME OF OUR ONGOING & COMPLETED PROJECTS



KOCHI

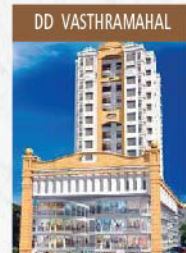
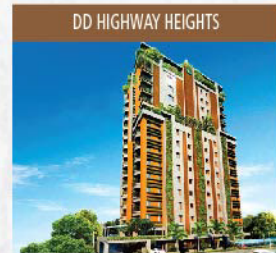
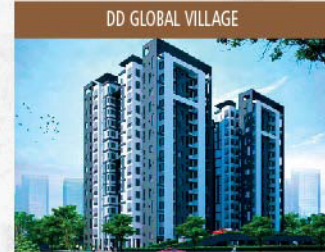
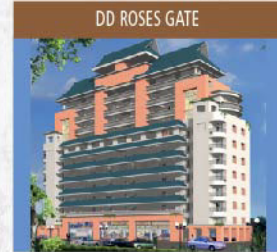
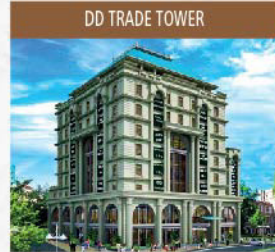
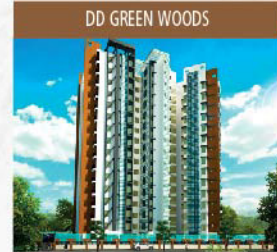
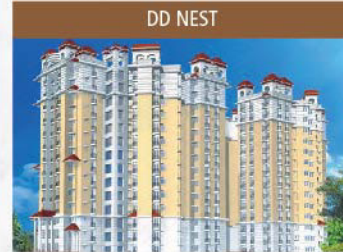
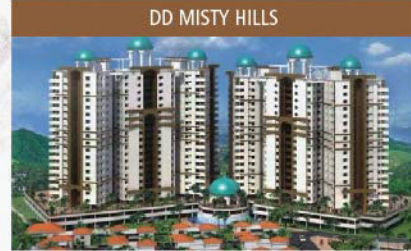
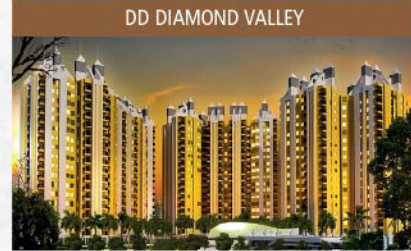

LOCATION MAP



PROXIMITY

METRO STATION	700 MTRS	EDAPPALLY Jn.	8 KMS
ALUVA	3 KMS	RAJAGIRI HOSPITAL	8 KMS
KALAMASSERY	3 KMS	AMRITA HOSPITAL	9 KMS
RAJAGIRI COLLEGE/ SCHOOL	3 KMS	ASTER MEDCITY	11 KMS
ALUVA RAILWAY STATION	3.5 KMS	COCHIN INTERNATIONAL AIRPORT	12 KMS
CUSAT	6 KMS	INFOPARK/ SMART CITY	12 KMS
KINDER HOSPITAL	7 KMS		